

SCP020EN	DATA SHEET	
Ref. 00 dtd 10/05/2011	MITERING MACHINE code 3000	

1. General Description:

The Mitering machine code 3000 is automatic and used to mitre Georgian bar for crossings and "T" junctions.

It has been conceived to reduce to a minimum set-up time, purpose achieved by a simple adjustment of vices to work both powder-coated and RENOLIT® or Hornschuch® foiled profiles.

This Mitering machine works 4 or 5 Georgian bars at the same time. It can also work all kinds of profiles of the same system without changing any equipment.

The machine is composed by:

- Control board
- Vices
- Linear adjustment
- Cutting discs
- Crankcase

2. Use:

This machine is equipped with two vices.

Unlike traditional production processes, where engines move, here it is the Georgian bar that moves. Such processing technique reduces vibration and increases cutting precision.

Once cut, the Georgian bars are assembled by internal keys, and the final result is shown hereunder:



This solution solves the problem of joining Georgian bars and centre keys of different colours or wood-grain finishes. Besides, it is cheaper than to milling system, because it allows to work also thinner Georgian bars (0.4 mm).

Work range:

- Height (H): from 5 mm to 10 mm
- Width (L): from 15 mm to 26 mm
- Thickness: from 0.4 mm

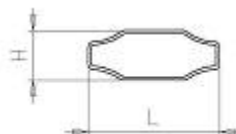

SCP020EN	DATA SHEET	
Ref. 00 dtd 10/05/2011	MITERING MACHINE code 3000	



Vices have been designed to suit both powder-coated and woodgrain-foiled Georgian bars, changing easily the kind of profile.

3. Specifications:

Dimensions:	500x900x1300 mm
Weight:	100 Kg
Voltage:	400 V AC
Pressure:	4,5-6 bar
Engine electric power:	1.0 KW
Cutting capacity:	4-5 Georgian bars at same time
Work range:	15-26 mm x 5-10 mm
<i>Thickness Wall:</i>	<i>> 0.4 mm</i>
Cutting angle:	45°
Cut:	complete

